

APPLICATIONS

- Separation systems
- Isolation applications
- Viscous & corrosive media
- High-pressure & vibration applications

FEATURES

- Economical and light weight
- All welded construction



FULLY WELDED DIAPHRAGM SEAL-HEVY DUTY, AN21

DESCRIPTION

General

Thread design : ANSI B1.20.1 / BS EN ISO 228-1

Storage temperature : -40...+65°C

Service temperature : 370°C max.

Weld joints : Laser welding for Diaphragm and
TIG argon arc welding for other parts

Material of construction

Sensing element : Diaphragm

Top chamber material : AISI 304 SS / AISI 316 SS

Diaphragm : AISI 316L SS / Monel 400 / Hastelloy C-276
Inconel 600 / Titanium / Tantalum

Bottom chamber material : AISI 304SS / AISI 316 SS
AISI 316L SS / Monel / Titanium / Tantalum
Hastelloy C-276

Capillary : AISI 304 SS / AISI 316 SS

Armour : AISI 304 SS / AISI 316 SS / PVC

Remote distance : 0.25 Mtr. to 15 Mtr.

Filling liquids Vs Temperature range

CODE	Fluid Name	Temperature Range	Seal type	Range	ØD
L1	Silicon DC 200	-40°C to 205°C	R04	-1...0...2.5 bar [Low Pressure]	Ø62.2
L2	Glycerin	10°C to 150°C	R05	4...70 bar [Standard]	Ø55.0
L3	Food Grade oil	-20°C to 140°C	R06	100...280 bar [High Pressure 1]	Ø46.5
L4	Syltherm 800	-40°C to 315°C	R07	350...700 bar [High Pressure 2]	Ø34.0
L5	Silicon DC 710	7°C to 371°C			

Standard version

Seal type : -1...0...2.5 bar [Low Pr.] / 6...70 bar [Standard]
100...280 bar [High Pr. 1] / 350...700 bar [High Pr. 2]

Instrument connection : ½" NPT (F) / ½" BSP (F)

Sealing fluid : Silicon DC 200 [-40...205°C]

Process connection : ½" NPT (M) / ½" BSP (M)

GA DRAWING

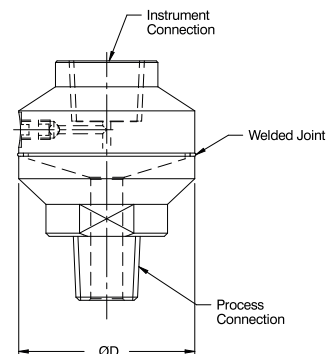

ORDERING CODES

MODEL

ANI21 Fully welded diaphragm

ANI21

SEAL TYPE

R04 -1...0...2.5 bar [Low Pressure] **R05** 4...70 bar [Standard] **R06** 100...280 bar [High Pressure 1]
R06 100...280 bar [High Pressure 1]

R02

TOP CHAMBER

S01 AISI 304 SS **S02** AISI 316 SS

S01

DIAPHRAGM

S03 AISI 316L SS **S05** Monel 400 **S10** Hastelloy C-276
S06 Inconel 600 **S07** Titanium **S08** Tantalum

S03

BOTTOM CHAMBER

S01 AISI 304 SS **S02** AISI 316 SS **S03** AISI 316L SS
S05 Monel 400 **S10** Hastelloy C-276 **S07** Titanium
S08 Tantalum

S02

INSTRUMENT CONNECTION

P28 ½" NPT (F) **P23** ¼" BSP (F) **P27** ½" BSP (F)
P24 ¼" NPT (F)

P28

PROCESS CONNECTION

P04 ¼" NPT (M) **P08** ½" NPT (M) **P20** M20 X 1.5 mm (M)
P03 ¼" BSP (M) **P05** 3/8" BSP (M) **P07** ½" BSP (M)
P28 ½" NPT (F) **P23** ¼" BSP (F) **P27** ½" BSP (F)
P24 ¼" NPT (F)

P08

All other connections are available on request.

SEALING FLUID

XX As per Filling liquid Vs Temperature Rating table

L1

EXECUTION

R1 Direct **R2** Remote

R1

CAPILLARY MATERIAL

S01 AISI 304 SS **S02** AISI 316 SS

XX

ARMOUR MATERIAL

S01 AISI 304 SS **S02** AISI 316 SS **S16** PVC [Ambient jÜ櫛°C]

XX

OTHER OPTIONS

E77 Dry Seal **E31** Material test certificate 3.1 **E32** Material test certificate 2.2

XXXXX

XXX

Ordering Example : ANI21-R02.S01.S03.S02.P28.P08.L1.R1/XX.XX.XXXXX/XXX

Note : For GA Drawings, kindly contact factory.

Plant I
 Kusumba, Sonarpur Station Road,
 Narendrapur - Kolkata 700 103.
 Land Mark: Allu Godown,
 West Bengal, India.
 Website : www.aninstruments.com

Plant II
 J. Nanji Industrial Park,
 Plot No. 78 & 79, Chiri Road,
 GIDC - 3rd Phase,
 Vapi - 396 195. Gujarat, India.
 Email : mktg@aninstruments.com

